



sasportonline.com

Sales & Service

SA Sport (Canada)
135 Forestview Road
P.O. Box 40
Orillia, Ontario
Canada L3V 6H9

Telephone: (705) 325-2274
Fax: (705) 325-1485
Toll Free: (800) 563-6479

SA Sport (U.S.A.)
7879 Will Rogers Blvd.
Fort Worth, Texas
USA 76140

Telephone: (817) 536-3366
Fax: (817) 536-3006
Toll Free: (800) 331-8068

133 LEATHER POMMEL HORSE

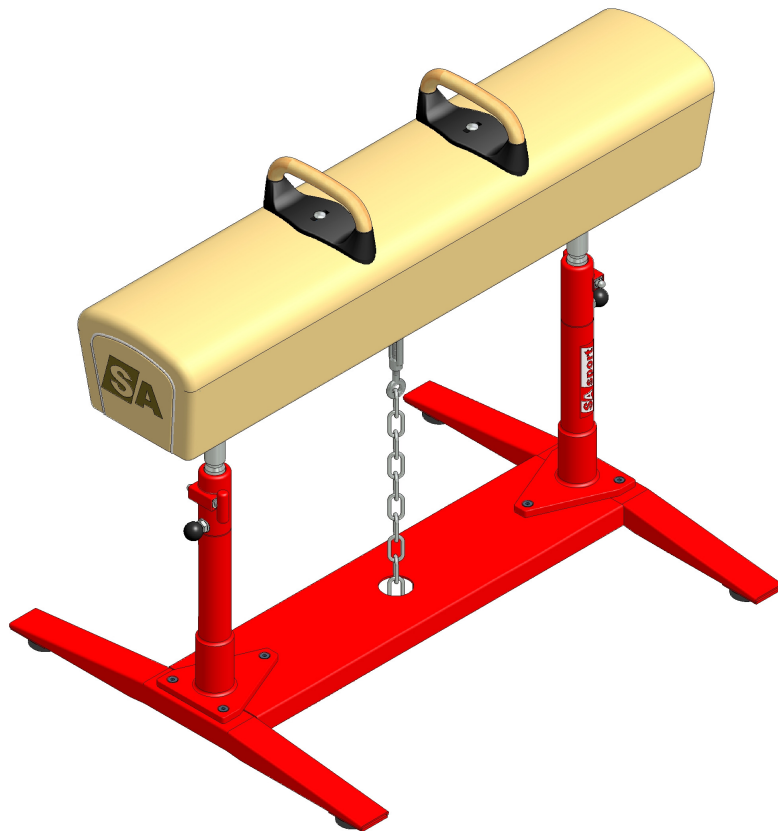

SECTION I

Introduction:

Thank you for purchasing a Pommel Horse from SA Sport. We appreciate your business and value you as a customer!

Your horse is constructed with the finest quality raw materials. We are sure you will be pleased with its quality, durability and performance. Your purchase includes a Chain Tie-Down system. For optimum safety, we strongly recommend that the Tie-Down be positioned every time the Pedestal Horse is in use.

All horses are carefully inspected before leaving our plant. SA Sport Pommel Horses are guaranteed for one (1) year against defective materials and workmanship. Proper assembly, height adjustment, maintenance and storage will ensure years of trouble-free use.

Please read the following instructions carefully before assembling or using your new piece of equipment.



The exclamation mark symbol when seen in this booklet is used to indicate warnings or items that require special attention during the use or assembly of the apparatus.



Only qualified persons should undertake assembly, installation and adjustment of this equipment. At no time should children or other unqualified persons undertake the assembly, installation or adjustment of this equipment.

You have received two (2) shipping cartons:

- One contains the Horse Top (Pommels & Pommel hardware)
- One contains the Pedestal Base, Locking Handles and Chain Tie-Down system

SECTION II

Layout of Area Required for the Pommel Horse

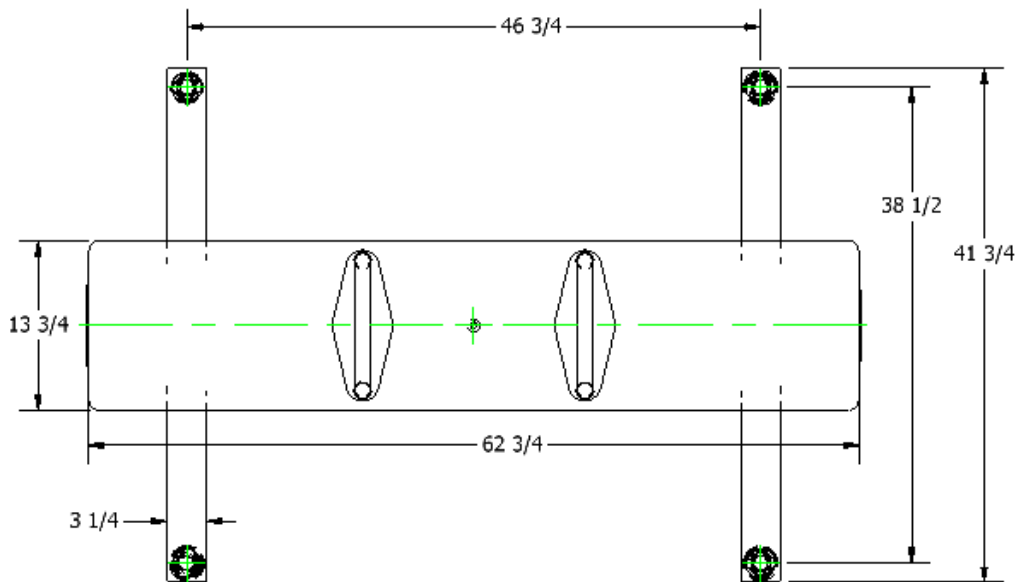

Assembly Instructions:

1. Remove the Pedestal Base from its carton and set it on the floor. Ensure it is level.
2. Place Locking Handles into the Pedestal Uprights and turn counter-clockwise until they are completely loosened. Make sure the 'V' shape in the blocks faces towards the adjusting shaft.
3. Open the Horse Top carton and remove loose Pommels and Pommel hardware. **Read the attached "Pommel Horse Preassembly Instruction" sheet before proceeding.**
4. Have 2 people lift the Horse Top out of the carton. Unfold and straighten both Adjusting Shafts. (See Fig. 1 on next page)
5. Lower the top and Adjusting Shafts carefully until they slide into the pedestal uprights.
6. While holding the Horse Top, pull the Snap Locks to allow the Adjusting Shaft to pass deeper into the Pedestal Upright.



The Horse Top has the potential to drop at this stage. Injury can occur as a result of this dropping. Stay well clear of the Adjusting Shafts!

7. When the Horse is at the desired height, release the Snap Locks and tighten both Locking Handles securely.
8. Check to ensure that both Adjusting Shafts are locked at the same height. Shake the Horse Top from the middle to center the body on the Adjusting Shafts
9. Tighten the Mounting Plate Bolts on the end of the Adjusting Shafts that connect to the underside of the Horse Top.
10. Assemble the Pommel Handles to the Horse Top as shown (see Fig. 2 on next page). Adjust to the desired width and tighten the Pommel Wing Nuts securely.

Figure 1

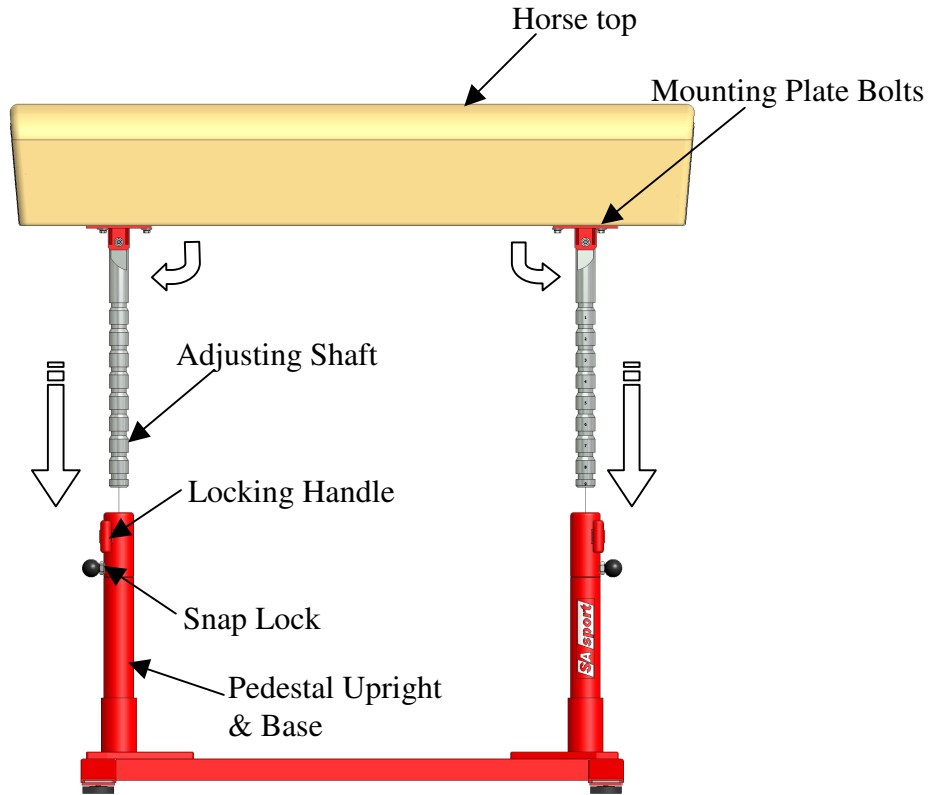
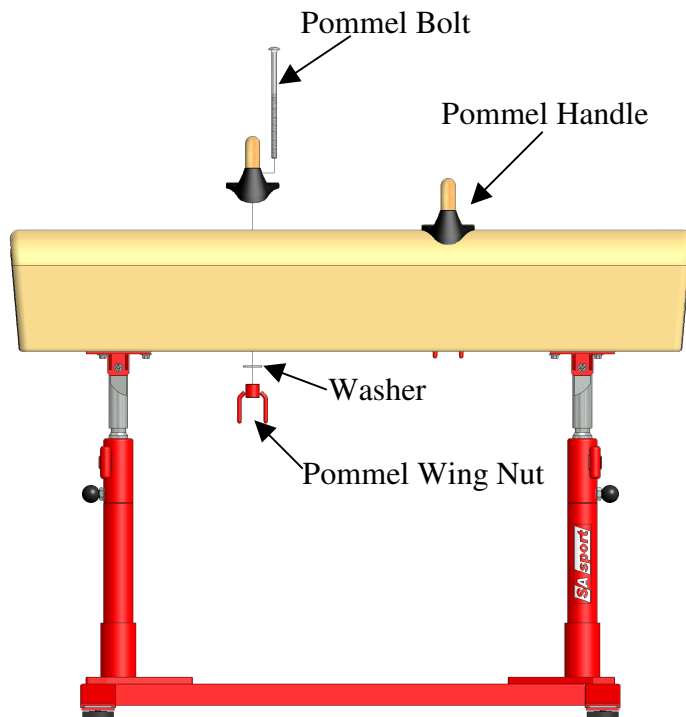

Figure 2



Anchoring Instructions:

To increase the stability of the pommel horse, a tie-down chain has been supplied that can be hooked from the Pommel Horse Body to a floor anchor & hook plate. The Floor Anchor (1/2" Thread Recommended) and 184A Hook Plate can be purchased separately from SA Sport.

1. Select a permanent location for the Pommel Horse that is flat and stable.
2. To install the floor anchor, see section III – *Installing Concrete Anchors*.
3. Thread a Hook Plate (not supplied) into the installed floor anchor (not supplied) and tighten securely.
4. Loosen the Turnbuckle to allow for tightening the system. Hook the Turnbuckle over the Anchoring Bar and the Tie Down Chain over the installed Hook Plate. (See Fig. 3 & 4)
5. Spin the Turnbuckle body by hand to tighten the tie-down chain to the desired tension. (See Fig. 4)

Figure 3

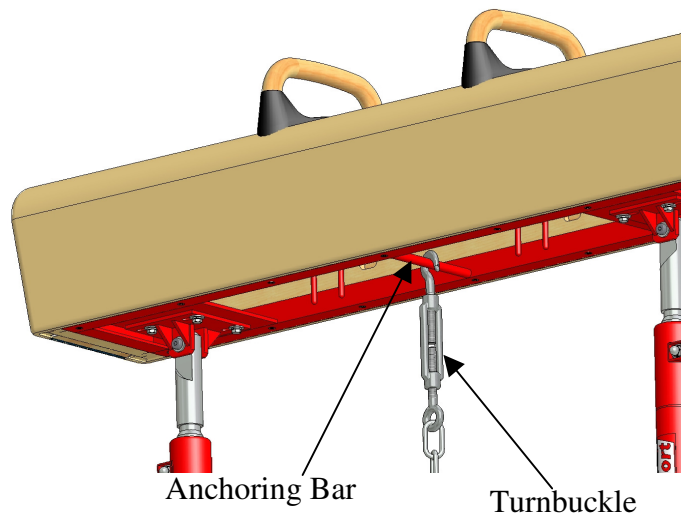
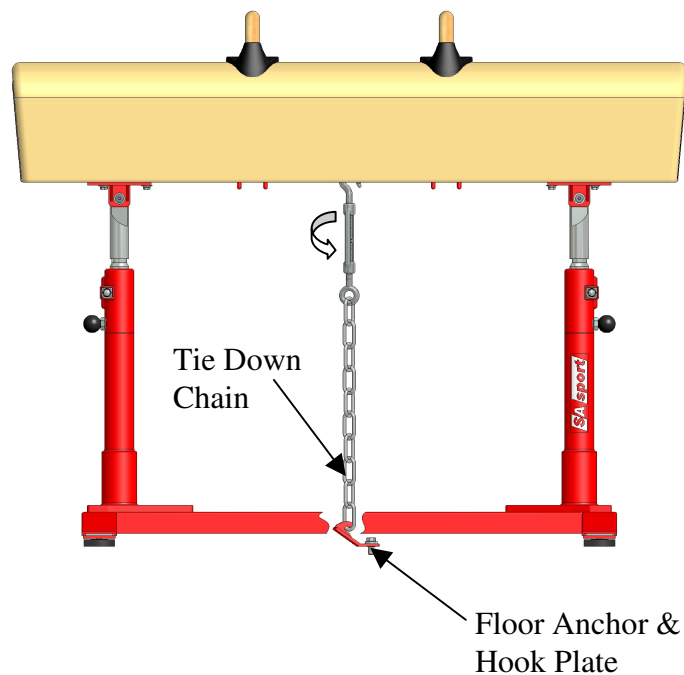

Figure 4



SECTION III

Installing concrete Anchors:



To determine anchor locations, please refer to the section for the specific equipment to be anchored.

Tools Required (customer supplied):

- Tape measure
- Anchor setting tool or punch with a $\frac{5}{16}$ " diameter & 1.5" long end
- $\frac{5}{8}$ " diameter carbide tipped concrete drill bit
- Hammer drill
- $\frac{3}{4}$ " Socket, Extension and Ratchet
- Hammer
- Safety glasses



Never place a floor anchor into a seam/crack, or an area within 9" from a seam/crack or outside edge of the concrete floor

1. With the $\frac{5}{8}$ " carbide drill bit installed in the Hammer drill, drill a hole into the concrete to 2 inches ($+\frac{1}{8}$ ").
2. Use a shop vacuum or turkey baster to remove all dust and concrete chips out of the holes. Ensure the hole depth is at least 2 inches ($+\frac{1}{8}$ ").
3. Turn a hex head bolt 3 full turns into a floor anchor, and insert it into the drilled hole (FIG 5).
4. Use the hammer to tap the top of the bolt until the floor anchor is flush with or just below the top of the concrete (FIG 5).
5. Remove the hex head bolt, proceed to set the anchor and lock it in place!

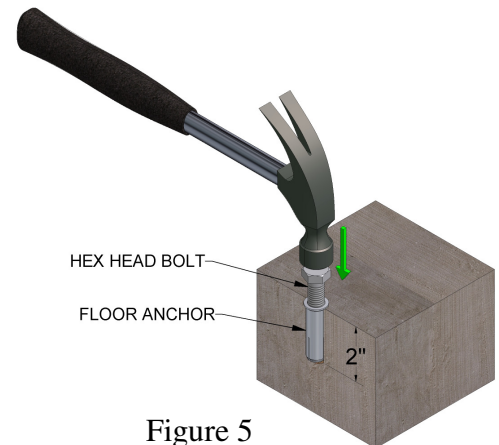

Figure 5



The step of locking or setting the anchors is critical; ensure that it is done correctly! (FIG 6)

6. Using a punch or setting tool (customer supplied), set the floor anchor by striking the plunger in the center of the floor anchor. Strike the setting tool or punch with a hammer repeatedly, to expand the anchor in the hole (FIG 6).

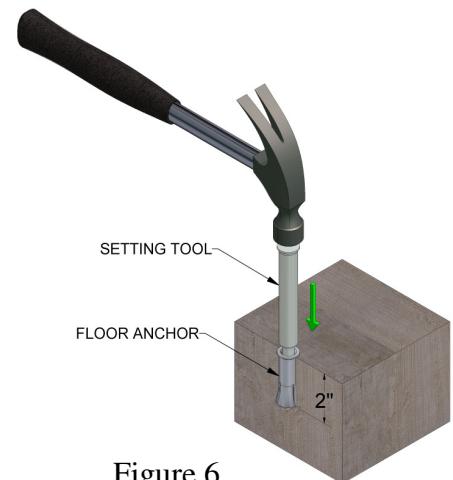

Figure 6



When securing equipment to floor anchors using bolts, a torque value of 20 ft lbs is recommended.

SECTION IV

Height Adjustment:

1. Have 2 people support the Horse Top from both ends.
2. Loosen both Locking Handles and pull the Snap Locks. (See Fig. 1)



The Horse Top has the potential to drop at this stage. Injury can occur as a result of this dropping. Stay well clear of the Adjusting Shafts!

3. When the desired height is reached (FIG height is 115 cm at notch marked '3'), release the snap locks and ensure they fully engage in an adjusting shaft notch. Firmly tighten both locking handles.

Pommel Width Adjustment:

1. Loosen the Pommel Wing Nut. (See Fig. 2)
2. Slide the Pommel Handles to the desired width. They can be adjusted from 40 cm to 45 cm wide.
3. Tighten the Pommel Wing Nuts securely.



This device will not be sufficiently stable unless the Locking Handles, Snap Locks and Pommel Wing Nuts are properly secured!

SECTION V

Maintenance:

- At every use check mechanical parts for signs of wear, damage or any loose components. Also inspect the Horse Top surface for signs of wear.
- At every use check that the horse is level and stable.
- Periodically check welds for signs of damage or fatigue.

SECTION VI

SAFETY WARNING



Any activity involving motion or height creates the possibility of serious injury including permanent paralysis and even death, from landing or falling on the neck, head, or other parts of the body.

You assume a risk of serious injury in using this equipment. However, this risk can be reduced by strictly following these rules at all times.

1. Use this equipment **only** under the supervision of a trained and qualified instructor.
2. This equipment **must be used only when protected by proper matting as recommended by the Federation of International Gymnasts (F.I.G.). If in doubt concerning proper matting, do not use this equipment.**
3. This equipment **must be used with proper spotting equipment and qualified spotters suitable to the activity or skill.** Always consult an instructor.
4. **Know your own limitations and the limitations of this equipment.** Follow progressive learning techniques and always consult an instructor.
5. **Always inspect this equipment for proper stability before each use.**
6. **Always inspect this equipment for loose fittings and parts. Replace any worn, defective or missing parts.**
7. **Always inspect this equipment for improper or unsafe installation. If in doubt, do not use this equipment.**